

Excelair
By Excelsior

Tower Fan – ETF 1200



USER MANUAL

FUNCTIONS & OPERATION

Put the plug into the socket, products in standby, power lamp light.

ON/OFF button: Push it to working state, push it again to standby .

SPEED button: Default setting is in medium speed, push "SPEED" button to set from High-Medium-Low.

SWING button : Push it to oscillate the fan, push it again to stop the function.

ION button: Press it to open to close the ion function.

Timer button: Press for 00-12 hours.

Turn off screen button: Press to open or close the display in screen.

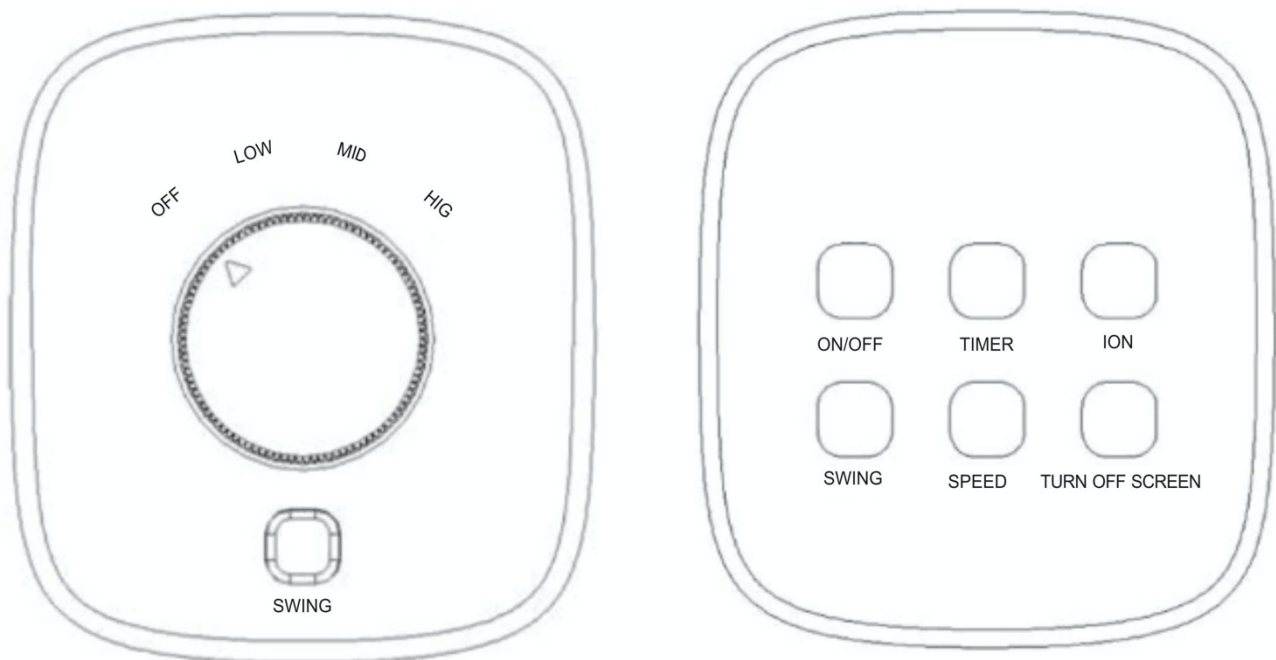

REMOTE CONTROL

Same as control panel

The remote control uses one button battery cells, model No. CR2025 (3V).

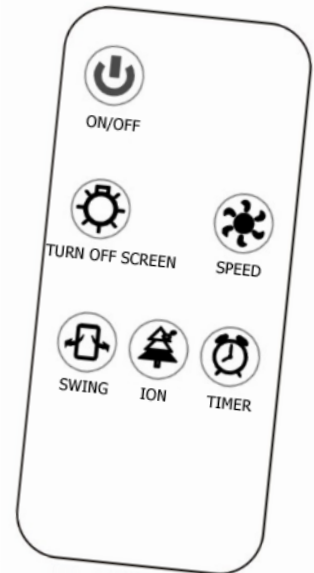
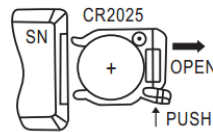
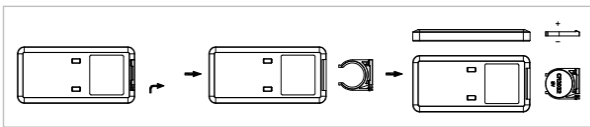

Note: Please follow battery disposal instruction on battery packaging, or contact your local councils for safely disposal of batteries.



WARNING - KEEP BATTERIES OUT OF REACH OF CHILDREN

- Swallowing may lead to serious injury in as little as 2 hours or death, due to chemical burns and potential perforation of the oesophagus.
- If you suspect your child has swallowed or inserted a button battery immediately call the 24-hour Poisons Information Centre on 13 11 26 for fast, expert advice.
- Examine devices and make sure the battery compartment is correctly secured, e.g. that the screw or other mechanical fastener is tightened. Do not use if compartment is not secure.
- Dispose of used button batteries immediately and safely. Flat batteries can still be dangerous.
- Tell others about the risk associated with button batteries and how to keep their children safe.

ASSEMBLING

- Step 1 : Make sure four hole of front and back base are in straight alignment, Put hole of back of base and insert to cylinder of front base.
- Step 2 : Take out the power cord from the center of the base
- Step 3 : Assembled base has four pieces of screw hole which fix into the screw holes of body ,use 4 pieces of tapping screw, fix closely the body and base. Finally take the power cord into the line hole.
- Step 4 : Put the fan on a flat even surface.

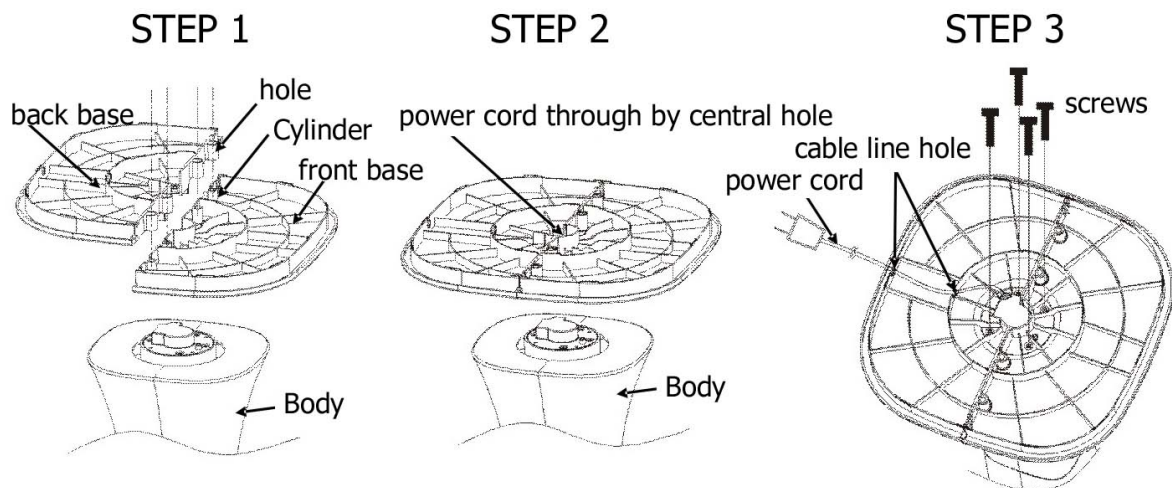

CAUTION

1. Use as per the rating voltage.
2. Do not repair or attempt to access the appliance internals it should be repaired by a qualified technician
3. Do not operate the appliance with wet hands, in order to avoid electric shock.
4. If the supply cord is damaged, it must be replaced by a same cord from the manufacturer or its service agents.
5. When the appliance is not in use, switch it off and unplug it.
6. Do not insert anything into air outlets and inlets, in order to avoid damage.
7. Do not use the appliance near explosive and combustible gas.
8. Use the appliance only on a flat surface.
9. Do not use outdoors.
10. Do not turnover the appliance. Unplug the power supply if it has toppled over and there is some water in the body. Dry the body before use.
11. Clean the appearance with a lightly damp cloth. It can be cleaned with neutral detergents. Do not rinse with water.
12. Do not make air outlets and inlets near the wall or curtain.
13. The appliance must not be located immediately below a socket outlet. The rating current of socket should not exceed 10A.
14. Do not use the appliance in the immediate surroundings of a bath, a shower or a swimming pool.
15. This appliance is not intended for use by persons including children with reduced physical, sensory or mental capabilities or lack of experience and knowledge unless they have been given supervision or instruction concerning use of the appliance by a person responsible for their safety.
16. Children should be supervised to ensure that they do not play with the appliance.

CLEANING AND MAINTENANCE

Clean with neutral detergent and soft cloth.

Attention: unplug the power plug when cleaning the appliance.

ACCESSORY

Screws for assemble the base ; Remote control

Excelair

By Excelsior

For any queries or assistance call
Customer Service
(Australia Only)
1300 174 876
Hours of operation:
Monday to Friday 8am - 5pm EST

IMPORTANT: RETAIN THESE INSTRUCTIONS FOR FUTURE USE.

Excelair™ is a trademark of Sitro Group Australia
www.excelsiorproducts.com.au